

INTERCEPT 1 Installation Sheet

NOTE: DO NOT ATTEMPT TO INSTALL THE INTERCEPT PRIOR TO READING THESE INSTRUCTIONS

- Step 1.** Prepare table per instructions on separate sheet. Be sure to retain portion of cut out tabletop if it will become the finished top of the INTERCEPT 1.
- Step 2.** Unpack the INTERCEPT 1, being careful not to damage any part, and check to ensure that no items were damaged during shipping. Review parts list to be sure all parts are present.
- Step 3.** TABLE THICKNESS ADJUSTMENT -The INNER PAN ASSY has four (4) adjustable mounting flanges that can be set for your specific table thickness between .656" - 1.625". The flanges come set for the thinnest table. To change the flanges remove the lock nuts (2 per flange) and move the flanges to the hole that corresponds with the table thickness that the INTERCEPT 1 will be mounted in.

Table Thickness
1.375" – 1.625"

Table Thickness
1.125" – 1.375"

Table Thickness
.83" – 1.125"

Table Thickness
.656" - .83"

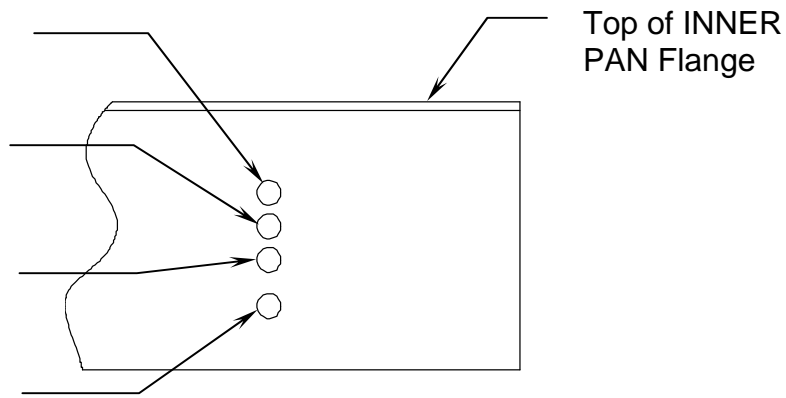

Tighten the lock nuts; be sure all of the flange tops are at the same height.

- Step 4.** TABLE CUTOUT MOUNTING - Attach CUTOUT PIECE, from table preparation to top of MAIN HOUSING *. The 8 pilot holes should line up. From underside of the INNER PAN, insert screws (use magnetic screwdriver) and secure the CUTOUT PIECE to the MAIN HOUSING.

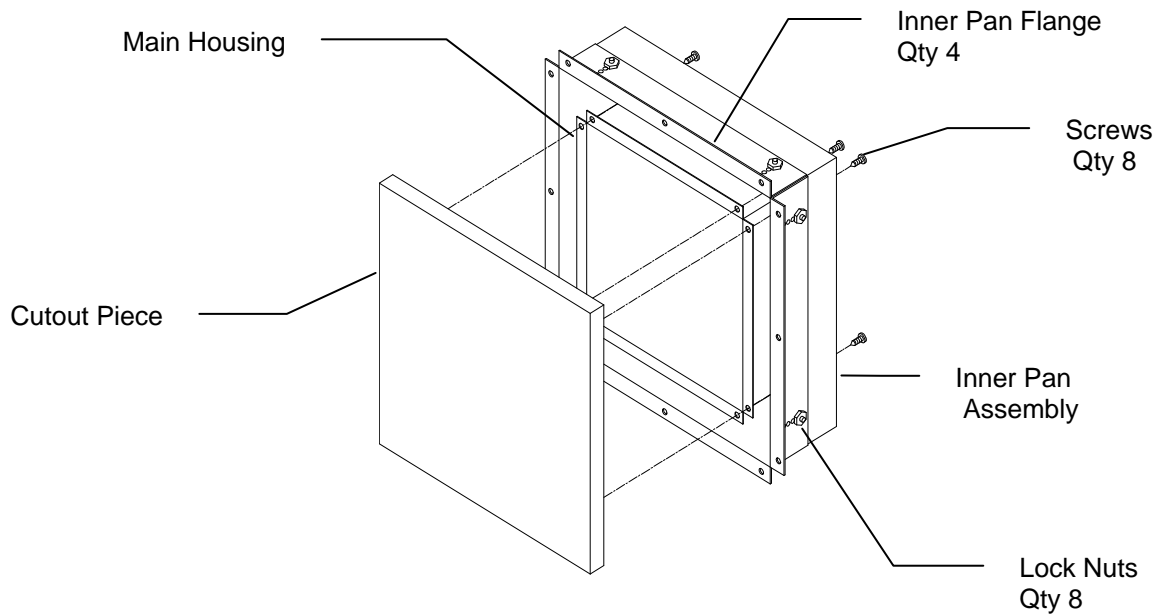

Step 5. INNER PAN MOUNTING - Place the INNER PAN ASSY to the underside of the table and secure with twelve (12) #10 X ½ screws provided, use pilot holes to ensure proper alignment. **NOTE:** USE CAUTION WHEN POSITIONING THE INTERCEPT 1 ON THE TABLE, ENSURE THAT THE GRAIN OF THE CUTOUT PIECE MATCHES THE TABLE.

#10 x ½ Screws
Qty 12 Included

(If other than included screws are used, be careful not to pierce finish side of table)

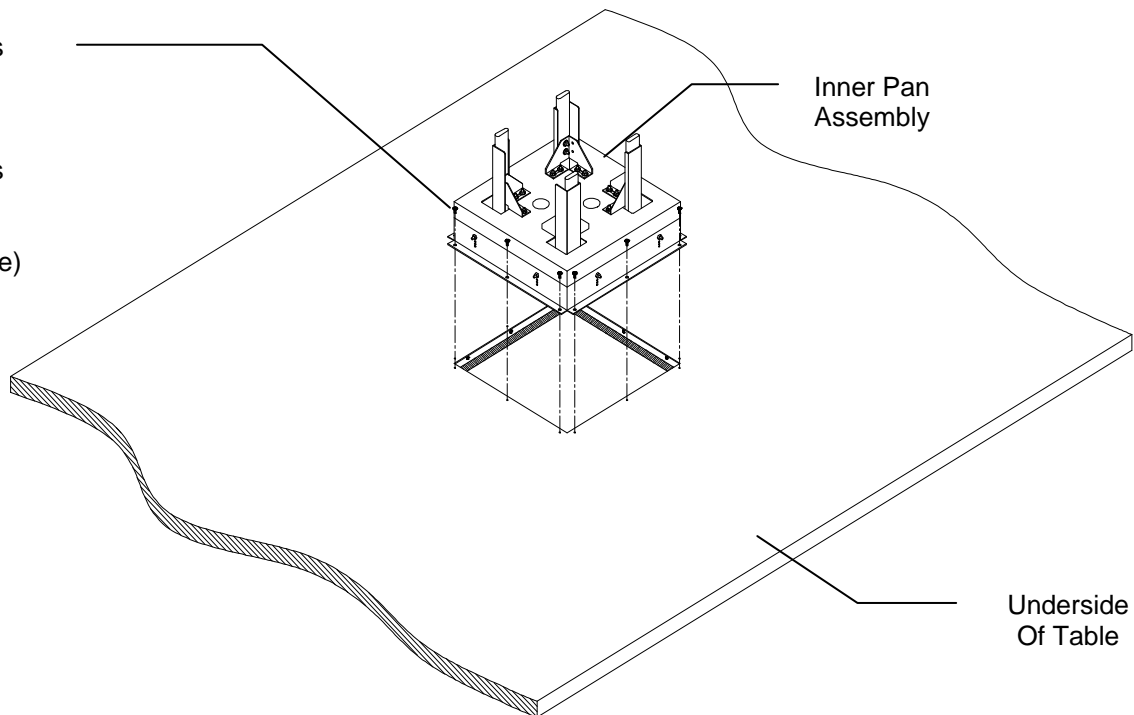

Innovative Power + Data Solutions

ECA • 10 Mountain View Drive • Shelton, CT 06484 • Phone: 1-800-521-3175 • Fax: 203-924-6687

www.electri-cable.com

Step 6. OUTER PAN MOUNTING - Position the OUTER PAN below the mounted INNER PAN ASSY. Be sure to feed the power plug through the cutout in the OUTER PAN. Attach the OUTER PAN to the underside of table with six (6) #10 X ½ screws provided. Use pilot holes to ensure proper alignment.

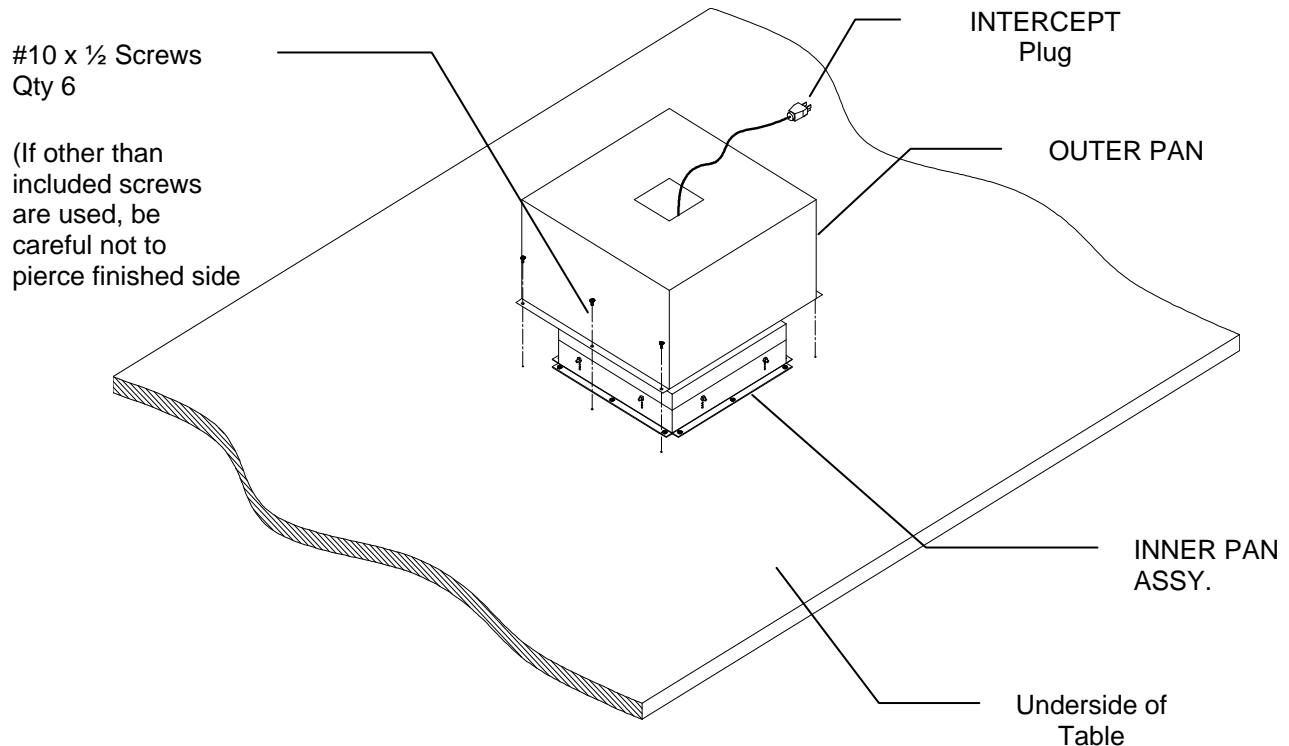

1. OPERATION - To *raise* the INTERCEPT 1, press down on the top of the INTERCEPT 1, in the center and release *. This movement releases the latch and allows the INTERCEPT 1 to rise to the upper limits of the springs. To *lower* the INTERCEPT 1, press the INTERCEPT 1 top, again at the center, downward as far as possible and release (some force is required to overcome the spring and operate the latching mechanism). Plug in the unit and test for proper operation.
NOTE: DO NOT USE EXCESSIVE FORCE WHEN OPERATING THE INTERCEPT.
2. VOICE/DATA CONNECTIONS - Raise the INTERCEPT 1 and snake the VOICE/DATA wires up through the OUTER PAN and through the 2 SHUTTER BUSHINGS in the bottom of the MAIN HOUSING. Wires should be dressed to move freely up and down with the movement of the MAIN HOUSING. This step can be done before mounting the INTERCEPT 1 however, be sure all wires are run through the cutout in the OUTER PAN before completing step 5.



* **NOTE:** If a CUTOUT PIECE other than the one obtained from the table preparation sheet, i.e. round, is to be used the following conditions need to be considered.

- ◆ The latching mechanism requires a minimum over-travel distance of ¼” to function properly.
- ◆ If the CUTOUT PIECE is larger than 13”, round or square, an interference with the INNER PAN ASSY can be expected. Provisions need to be made for the required over-travel.
- ◆ No modifications to the Intercept should be made. Any modifications, in addition to voiding any warranty, can effect the proper operation of the Intercept.

Congratulations. Enjoy your Intercept 1.

PARTS LIST

Inner Pan Assembly	Qty 1
Outer Pan (optional)	Qty 1
Table Brush	Qty 4
7/64 Allen Wrench	Qty 1
#10 X ½ Pan Head Screw	Qty 20
#4 X ½ Pan Head Screw	Qty 12
Table Preparation Instructions	Qty 1
Installation Instructions	Qty 1
Housing Adjustment Instructions	Qty 1

Innovative Power + Data Solutions

ECA • 10 Mountain View Drive • Shelton, CT 06484 • Phone: 1-800-521-3175 • Fax: 203-924-6687

www.electri-cable.com

9065-0005 Rev F

ELECTRI-CABLE ASSEMBLIES